

## IVM 60/36 -3

3-motor, mobile and robust middle-class industrial vacuum cleaner IVM 60/36-3 for universal use in industry for fine and coarse solid materials. With star filter in dust class M.



Made in Germany



### Order no.

1.573-320.0

- Anti-static equipment
- Extra-large filter area
- Robust wheels and castors

### Technical data

<b>EAN code</b>		4054278325668
<b>Supply voltage</b>	<b>Ph / V / Hz</b>	1 / 220 - 240 / 50 - 60
<b>Air flow</b>	<b>l/s / m³/h</b>	221 / 799
<b>Vacuum</b>	<b>mbar / kPa</b>	254 / 25.4
<b>Container content</b>	<b>l</b>	60
<b>Rated input power</b>	<b>kW</b>	3.6
<b>Vacuuming type</b>		Electric
<b>Connection nominal diameter</b>		ID 70
<b>Accessory nominal diameter</b>		ID 70 / ID 50 / ID 40
<b>Sound pressure level</b>	<b>dB(A)</b>	79
<b>Main filter dust class</b>		M
<b>Filter area for main filter</b>	<b>m²</b>	2.2
<b>Weight without accessories</b>	<b>kg</b>	68
<b>Weight incl. packaging</b>	<b>kg</b>	71.8
<b>Dimensions (L × W × H)</b>	<b>mm</b>	1020 × 680 × 1490

Users must receive training on this device.

### Equipment

<b>Main filter</b>	Star filter
<b>Accessories included in the scope of delivery</b>	no
<b>Container emptying</b>	Set-down trolley
<ul style="list-style-type: none"> <li>▪ Included in the scope of supply.</li> </ul>	



### Fitted with three blower motors

- Three powerful fans for impressive cleaning performance.
- Fans can be switched on separately for individual suction power as required.



### Manual IVM filter cleaning

- Effortless operation by means of an ergonomically placed lever if required.
- Extends the life of the filter and thus reduces the maintenance effort.
- Identical cleaning results, regardless of the amount of force used.



### Equipped with extra-large star filter

- For safely vacuuming solids and dusts up to dust class M.
- Also suitable for large quantities of dust.

## ACCESSORIES FOR IVM 60/36 -3 1.573-320.0



		Order no.	Description	
<b>ACCESSORY SETS</b>				
<b>Accessory kit for solids/dust</b>				
Oven cleaning accessory kit DN 50	1	9.989-938.0	Accessory kit for oven cleaning: ME hose 3 m (9.989-979.0), handle (9.989-899.0), suction tube (9.989-929.0), floor nozzle (9.989-935.0), reducer (9.989-712.0), adapter (9.993-011.0).	<input type="checkbox"/>
Oven cleaning accessory kit DN 40	2	9.989-939.0	Accessory kit for oven cleaning: ME hose 3 m (9.989-976.0), handle (9.989-898.0), suction tube (9.989-928.0), floor nozzle (9.989-934.0), reducer (9.989-713.0), adapter (9.993-012.0).	<input type="checkbox"/>
Food accessory kit DN 40	3	9.989-940.0	Food accessory kit DN 40: PU hose 3 m (9.989-970.0), handle (9.989-898.0), standard nozzle (9.989-838.0), brush (9.989-879.0), reducer (9.989-713.0), adapter (9.993-012.0).	<input type="checkbox"/>
Food accessory kit DN 50	4	9.989-941.0	Food accessory kit: PU hose 3 m (9.989-973.0), handle (9.989-899.0), standard nozzle (9.989-844.0), brush (9.989-880.0), reducer (9.989-712.0), adapter (9.993-011.0).	<input type="checkbox"/>
Accessory kit for overhead cleaning DN 40	5	9.989-942.0	Accessory kit DN 40 for overhead cleaning: suction tubes (9.989-920.0/9.993-008.0), handles (9.989-916.0/9.989-918.0), standard nozzle (9.989-838.0), brush (9.989-879.0), adapter (9.993-012.0).	<input type="checkbox"/>
Accessory kit for overhead cleaning DN 50	6	9.989-943.0	Accessory kit DN 50 for overhead cleaning: suction tubes (9.989-921.0/9.993-009.0), handles (9.989-917.0/9.989-919.0), standard nozzle (9.989-844.0), brush (9.989-880.0), adapter (9.993-011.0).	<input type="checkbox"/>
Accessory kit for solids/dust DN 50	7	9.989-662.0	Accessory kit DN 50 for industrial vacuum cleaners (solids and dust): EVA hose (9.988-090.0), handle (9.977-678.0), standard nozzle (9.988-402.0), reducer (9.977-772.0).	<input type="checkbox"/>
<b>NOZZLES</b>				
<b>Standard nozzles</b>				
Standard nozzle silicone FDA blue DN-F40	8	9.989-835.0		<input type="checkbox"/>
Standard nozzle silicone FDA green DN-F40	9	9.989-836.0		<input type="checkbox"/>
Standard nozzle silicone FDA red DN-F40	10	9.989-837.0		<input type="checkbox"/>
Standard nozzle silicone FDA transparent DN-F40	11	9.989-838.0		<input type="checkbox"/>
Standard nozzle silicone FDA white DN-F40	12	9.989-839.0		<input type="checkbox"/>
Standard nozzle silicone FDA yellow DN-F40	13	9.989-840.0		<input type="checkbox"/>
Standard nozzle silicone FDA blue DN-F50	14	9.989-841.0		<input type="checkbox"/>

■ Included in the scope of supply. □ Available accessories.

## ACCESSORIES FOR IVM 60/36 -3 1.573-320.0



		Order no.	Description	
<b>NOZZLES</b>				
<b>Standard nozzles</b>				
Standard nozzle silicone FDA green DN-F50	15	9.989-842.0		<input type="checkbox"/>
Standard nozzle silicone FDA red DN-F50	16	9.989-843.0		<input type="checkbox"/>
Standard nozzle silicone FDA transparent DN-F50	17	9.989-844.0		<input type="checkbox"/>
Standard nozzle silicone FDA white DN-F50	18	9.989-845.0		<input type="checkbox"/>
Standard nozzle silicone FDA yellow DN-F50	19	9.989-846.0		<input type="checkbox"/>
Standard PVC nozzle DN40	20	9.989-674.0	Electroconductive standard PVC nozzle. DN 40.	<input type="checkbox"/>
Standard PVC nozzle DN50	21	9.989-673.0	Electroconductive standard PVC nozzle. DN 50.	<input type="checkbox"/>
Standard PVC nozzle DN70	22	9.989-676.0	Electroconductive standard PVC nozzle. DN 70.	<input type="checkbox"/>
Standard nozzle silicone DN40	23	9.988-401.0	Stretchy standard nozzle made from silicone, inner cone DN 40.	<input type="checkbox"/>
Standard nozzle silicone DN50	24	9.988-402.0		<input type="checkbox"/>
Standard silicone nozzle DN70	25	9.989-672.0	Electroconductive standard silicone nozzle. DN 70.	<input type="checkbox"/>
Standard nozzle cuttable rubber DN40	26	9.989-677.0	Standard nozzle, electroconductive, made from cuttable rubber. DN 40.	<input type="checkbox"/>
Standard nozzle cuttable rubber DN50	27	9.989-675.0	Standard nozzle, electroconductive, made from cuttable rubber. DN 50.	<input type="checkbox"/>
Standard aluminium nozzle DN40	28	9.980-748.0	Diagonal nozzle made from anodised aluminium, electroconductive, DN 40.	<input type="checkbox"/>

■ Included in the scope of supply. □ Available accessories.

## ACCESSORIES FOR IVM 60/36 -3 1.573-320.0

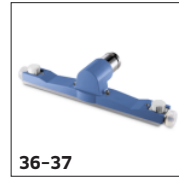
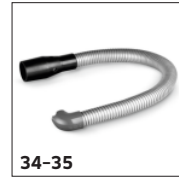
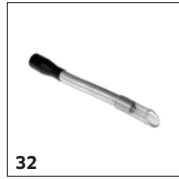
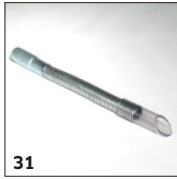
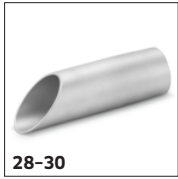

	Order no.	Description	
<b>NOZZLES</b>			
<b>Standard nozzles</b>			
Standard aluminium nozzle DN50	29	9.980-749.0	Diagonal nozzle made from anodised aluminium, electroconductive, DN 50. <input type="checkbox"/>
Standard aluminium nozzle DN70	30	9.989-663.0	Standard nozzle made from aluminium. Electroconductive. DN 70. <input type="checkbox"/>
<b>Flexible standard nozzles</b>			
Standard nozzle flexible PVC DN40	31	9.981-420.0	Electroconductive, flexible round nozzle made from galvanised steel, with rubber mouthpiece DN 30. <input type="checkbox"/>
Standard nozzle flexible PVC DN50	32	9.981-421.0	Electroconductive, flexible round nozzle made from galvanised steel, DN 50, with rubber mouthpiece DN 30. <input type="checkbox"/>
Standard nozzle flexible PVC DN70	33	9.981-422.0	Flexible, electroconductive standard nozzle, DN 70, with rubber mouthpiece. <input type="checkbox"/>
Standard nozzle, flexible, angled 90° PP DN40	34	9.981-429.0	Flexible, electroconductive angled nozzle, DN 40, length: 800 mm. <input type="checkbox"/>
Standard nozzle, flexible, angled 90° PP DN50	35	9.981-430.0	Flexible, electroconductive angled nozzle, DN 50, length: 800 mm. <input type="checkbox"/>
<b>Floor nozzles</b>			
Floor nozzle stainless steel AISI 304 DN-F40 blue	36	9.989-861.0	<input type="checkbox"/>
Floor nozzle stainless steel AISI 316L DN-F50 blue	37	9.989-862.0	<input type="checkbox"/>
Floor nozzle stainless steel AISI 316L DN-F40 green	38	9.989-863.0	<input type="checkbox"/>
Floor nozzle stainless steel AISI 316L DN-F50 green	39	9.989-864.0	<input type="checkbox"/>
Floor nozzle stainless steel AISI 316L DN-F40 red	40	9.989-865.0	<input type="checkbox"/>
Floor nozzle stainless steel AISI 316L DN-F50 red	41	9.989-866.0	<input type="checkbox"/>
Floor nozzle stainless steel AISI 316L DN-F40 transparent	42	9.989-867.0	<input type="checkbox"/>

■ Included in the scope of supply.  Available accessories.

## ACCESSORIES FOR IVM 60/36 -3 1.573-320.0

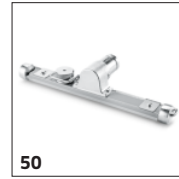

	Order no.	Description		
<b>NOZZLES</b>				
<b>Floor nozzles</b>				
Floor nozzle stainless steel AISI 316L DN-F50 transparent	43	9.989-868.0	<input type="checkbox"/>	
Floor nozzle stainless steel AISI 316L DN-F40 white	44	9.989-869.0	<input type="checkbox"/>	
Floor nozzle stainless steel AISI 316L DN-F50 white	45	9.989-870.0	<input type="checkbox"/>	
Floor nozzle stainless steel AISI 316L DN-F40 yellow	46	9.989-871.0	<input type="checkbox"/>	
Floor nozzle stainless steel AISI 316L DN-F50 yellow	47	9.989-872.0	<input type="checkbox"/>	
Floor nozzle stainless steel AISI 316L DN-F40	48	9.989-914.0	<input type="checkbox"/>	
Floor nozzle stainless steel AISI 316L DN-F50	49	9.989-915.0	<input type="checkbox"/>	
Floor nozzle stainless steel 400 mm DN-F40	50	9.989-934.0	<input type="checkbox"/>	
Floor nozzle stainless steel 400 mm DN-F50	51	9.989-935.0	<input type="checkbox"/>	
Floor nozzle aluminium 400 mm DN-F40	52	9.989-936.0	<input type="checkbox"/>	
Floor nozzle aluminium 400 mm DN-F50	53	9.989-937.0	<input type="checkbox"/>	
Aluminium floor nozzle 370 mm DN40	54	9.989-683.0	Floor nozzle, 370 mm, made from aluminium. DN 40.	<input type="checkbox"/>
Aluminium floor nozzle, el, 370 mm, DN40	55	9.989-682.0	Floor nozzle, 370 mm, made from aluminium. Electroconductive. DN 40.	<input type="checkbox"/>
Aluminium floor nozzle 200 mm DN50	56	9.981-426.0	Floor nozzle, DN 50, with 200 mm suction width.	<input type="checkbox"/>

■ Included in the scope of supply. □ Available accessories.

## ACCESSORIES FOR IVM 60/36 -3 1.573-320.0



54, 57-58



59-60



55, 61

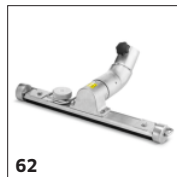

62

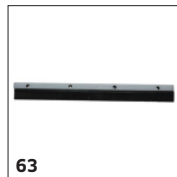

63



64-65

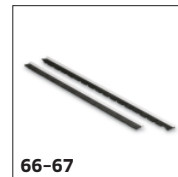

66-67



68-69



70-71

		Order no.	Description	
<b>NOZZLES</b>				
<b>Floor nozzles</b>				
Aluminium floor nozzle 370 mm DN50	57	9.989-664.0	Floor nozzle. 370 mm, made from aluminium. Electroconductive. DN 50.	<input type="checkbox"/>
Aluminium floor nozzle, el. 370 mm, DN50	58	9.987-612.0	Electroconductive multi-purpose floor nozzle. 370 mm wide, DN 50.	<input type="checkbox"/>
Aluminium floor nozzle 500 mm DN50	59	9.989-684.0	Floor nozzle, 500 mm, made from aluminium. Electroconductive. DN 50.	<input type="checkbox"/>
Aluminium floor nozzle, el. 500 mm, DN50	60	9.981-925.0	Floor nozzle with 500 mm suction width and hinge. DN 50, electroconductive.	<input type="checkbox"/>
Stainless steel floor nozzle el 370 mm DN40	61	9.989-558.0	Multi-purpose floor nozzle (370 mm), electroconductive, DN 40.	<input type="checkbox"/>
Stainless steel floor nozzle el 370 mm DN50	62	9.988-115.0	Floor nozzle (370 mm) made from stainless steel, electroconductive, DN 50.	<input type="checkbox"/>
Floor nozzle rubber strip oil-resistant. 220 mm	63	9.981-923.0	Squeegee with plastic strip for floor nozzle, 220 mm wide.	<input type="checkbox"/>
Floor nozzle rubber strip 370 mm	64	9.981-914.0	Squeegee with profiled strip for floor nozzle, 370 mm wide.	<input type="checkbox"/>
Floor nozzle rubber strip 500 mm	65	9.981-915.0	Oil-resistant squeegee with profiled strip for floor nozzle, 500 mm wide.	<input type="checkbox"/>
Floor nozzle brush strip el. 370 mm	66	9.984-939.0	Electroconductive squeegee for floor nozzle, 370 mm wide.	<input type="checkbox"/>
Floor nozzle brush strip 500 mm	67	9.980-764.0	Brush strip set for floor nozzle 500 mm, with profiled strip.	<input type="checkbox"/>
<b>Crevice nozzles</b>				
Crevice nozzle PP 15 mm × 145 mm DN40	68	9.988-116.0	Electroconductive, flat multi-purpose crevice nozzle made from plastic, DN 42.	<input type="checkbox"/>
Crevice nozzle PP 15 mm × 145 mm DN50	69	9.988-117.0	Electroconductive, flat multi-purpose crevice nozzle made from plastic, DN 52.	<input type="checkbox"/>
Crevice nozzle PU 19 mm × 160 mm DN40	70	9.981-483.0	Crevice nozzle made from PU, DN 40.	<input type="checkbox"/>

Available accessories.

## ACCESSORIES FOR IVM 60/36 -3 1.573-320.0



	Order no.	Description	
<b>NOZZLES</b>			
<b>Crevice nozzles</b>			
Crevice nozzle PU 22 mm × 175 mm DN50	71	9.981-482.0	Crevice nozzle made from PU, DN 50. <input type="checkbox"/>
Crevice nozzle 17 mm × 120 mm DN40	72	9.989-680.0	Electroconductive crevice nozzle, 17 × 120 mm. DN 40. <input type="checkbox"/>
Crevice nozzle 25 mm × 120 mm DN40	73	9.989-678.0	Electroconductive crevice nozzle, 25 × 120 mm. DN 40. <input type="checkbox"/>
Crevice nozzle 18 mm × 120 mm DN50	74	9.981-442.0	Electroconductive crevice nozzle made from sheet steel, DN 50, with 17 mm slot width. <input type="checkbox"/>
Crevice nozzle 25 mm × 120 mm DN50	75	9.981-465.0	Electroconductive crevice nozzle made from sheet steel, DN 50, with 25 mm slot width. <input type="checkbox"/>
Crevice nozzle 28 mm × 120 mm DN70	76	9.981-444.0	Electroconductive crevice nozzle made from sheet steel, DN 70, with 30 mm slot width. <input type="checkbox"/>
Stainless steel crevice nozzle 17 mm × 120 mm DN40	77	9.989-193.0	Crevice nozzle made from stainless steel, DN 50. <input type="checkbox"/>
Stainless steel crevice nozzle 22 mm × 220 mm DN50	78	9.988-123.0	Stainless steel crevice nozzle, DN 42, suitable for use with foods. <input type="checkbox"/>
<b>Flexible crevice nozzles</b>			
Crevice nozzle flexible silicone FDA DN-F50 transparent	79	9.989-847.0	<input type="checkbox"/>
Crevice nozzle flexible silicone FDA DN-F40 transparent	80	9.989-848.0	<input type="checkbox"/>
Flexible crevice nozzle silicone 65 mm DN50	81	9.988-403.0	Flexible crevice nozzle made from silicone, DN 50. <input type="checkbox"/>
Flexible crevice nozzle 11 mm × 58 mm DN40	82	9.989-681.0	Electroconductive and flexible crevice nozzle, 11 × 58 mm. <input type="checkbox"/>
Flexible crevice nozzle 20 mm × 45 mm DN40	83	9.981-423.0	Flexible and electroconductive crevice nozzle made from galvanised steel with 20 mm slot width, DN 40. <input type="checkbox"/>
Flexible crevice nozzle 12 mm × 45 mm DN50	84	9.981-424.0	Flexible, electroconductive galvanised crevice nozzle, DN 50, with 13 mm slot width. <input type="checkbox"/>

Available accessories.



## ACCESSORIES FOR IVM 60/36 -3 1.573-320.0



	Order no.	Description	
<b>NOZZLES</b>			
<b>Flexible crevice nozzles</b>			
Flexible crevice nozzle 20 mm x 45 mm DN50	85	9.981-425.0	Flexible and electroconductive crevice nozzle made from galvanised steel with 20 mm slot width, DN 50.
<b>Surface nozzles</b>			
Silicone surface nozzle FDA blue DN-F40	86	9.989-849.0	<input type="checkbox"/>
Silicone surface nozzle FDA blue DN-F50	87	9.989-850.0	<input type="checkbox"/>
Silicone surface nozzle FDA green DN-F40	88	9.989-851.0	<input type="checkbox"/>
Silicone surface nozzle FDA green DN-F50	89	9.989-852.0	<input type="checkbox"/>
Silicone surface nozzle FDA red DN-F40	90	9.989-853.0	<input type="checkbox"/>
Silicone surface nozzle FDA red DN-F50	91	9.989-854.0	<input type="checkbox"/>
Silicone surface nozzle FDA transparent DN-F40	92	9.989-855.0	<input type="checkbox"/>
Silicone surface nozzle FDA transparent DN-F50	93	9.989-856.0	<input type="checkbox"/>
Silicone surface nozzle FDA white DN-F40	94	9.989-857.0	<input type="checkbox"/>
Silicone surface nozzle FDA white DN-F50	95	9.989-858.0	<input type="checkbox"/>
Silicone surface nozzle FDA yellow DN-F40	96	9.989-859.0	<input type="checkbox"/>
Silicone surface nozzle FDA yellow DN-F50	97	9.989-860.0	<input type="checkbox"/>
Silicone surface nozzle 120 mm DN40	98	9.988-118.0	Electroconductive rubber nozzle, angled, DN 40, suitable for use with foods.

Available accessories.

## ACCESSORIES FOR IVM 60/36 -3 1.573-320.0



		Order no.	Description	
<b>NOZZLES</b>				
<b>Surface nozzles</b>				
Silicone surface nozzle 120 mm DN50	99	9.988-119.0	Electroconductive rubber nozzle, angled, DN 50, suitable for use with foods.	<input type="checkbox"/>
Aluminium surface nozzle, 150 mm, DN 40	100	9.989-666.0	Surface nozzle, 150 mm, made from aluminium. DN 40.	<input type="checkbox"/>
Aluminium surface nozzle 150 mm DN50	101	9.989-665.0	Surface nozzle, 150 mm, made from aluminium. DN 50.	<input type="checkbox"/>
<b>Borehole nozzles</b>				
Blind hole nozzle DN40	102	9.989-671.0	90° curved blind hole nozzle with 60 mm diameter.	<input type="checkbox"/>
Blind hose nozzle angled 60° DN40	103	9.989-669.0	90° curved blind hole nozzle with 48 mm diameter. DN 40.	<input type="checkbox"/>
Blind hose nozzle angled 90° DN40	104	9.989-667.0	90° curved blind hole nozzle with 60 mm diameter. DN 40.	<input type="checkbox"/>
Blind hose nozzle angled 90° 200 mm extension DN40	105	9.989-670.0	90° curved blind hole nozzle with 48 mm diameter. DN 40.	<input type="checkbox"/>
<b>BRUSHES</b>				
<b>Standard brushes</b>				
Standard brush 40 mm DN40	106	9.981-431.0	Flat brush nozzle DN 40.	<input type="checkbox"/>
Standard brush 40 mm DN50	107	9.981-432.0	Flat brush nozzle DN 50.	<input type="checkbox"/>
<b>End brushes</b>				
Brush FDA blue ø 75 mm DN-F40	108	9.989-873.0		<input type="checkbox"/>
Brush FDA blue ø 75 mm DN-F50	109	9.989-874.0		<input type="checkbox"/>
Brush FDA green ø 75 mm DN-F40	110	9.989-875.0		<input type="checkbox"/>
Brush FDA green ø 75 mm DN-F50	111	9.989-876.0		<input type="checkbox"/>
Brush FDA red ø 75 mm DN-F40	112	9.989-877.0		<input type="checkbox"/>

Available accessories.

## ACCESSORIES FOR IVM 60/36 -3 1.573-320.0



	Order no.	Description		
<b>BRUSHES</b>				
<b>End brushes</b>				
Brush FDA red ø 75 mm DN-F50	113	9.989-878.0	<input type="checkbox"/>	
Brush FDA white ø 75 mm DN-F40	114	9.989-879.0	<input type="checkbox"/>	
Brush FDA white ø 75 mm DN-F50	115	9.989-880.0	<input type="checkbox"/>	
Brush FDA yellow ø 75 mm DN-F40	116	9.989-881.0	<input type="checkbox"/>	
Brush FDA yellow ø 75 mm DN-F50	117	9.989-882.0	<input type="checkbox"/>	
End brush Ø 82 mm DN40	118	9.989-609.0	Electroconductive end brush with 82 mm diameter. DN 40.	<input type="checkbox"/>
End brush Ø 82 mm DN50	119	9.989-608.0	Electroconductive end brush with 82 mm diameter. DN 50.	<input type="checkbox"/>
<b>Surface brushes</b>				
Surface brush PP 24 mm DN40	120	9.989-610.0	Electroconductive surface brush. DN 40.	<input type="checkbox"/>
Surface brush 300 mm DN40	121	9.981-911.0	Vacuum brush, 300 mm, with 45° connection, with star screw, horsehair bristles.	<input type="checkbox"/>
Surface brush 300 mm DN50	122	9.981-912.0		<input type="checkbox"/>
<b>Cylinder brushes</b>				
Cylinder brush ø 100 mm DN-F40	123	9.989-922.0	<input type="checkbox"/>	
Cylinder brush ø 200 mm DN-F40	124	9.989-923.0	<input type="checkbox"/>	
Cylinder brush ø 100 mm DN-F50	125	9.989-925.0	<input type="checkbox"/>	
Cylinder brush ø 200 mm DN-F50	126	9.989-926.0	<input type="checkbox"/>	

Available accessories.

## ACCESSORIES FOR IVM 60/36 -3 1.573-320.0



	Order no.	Description	
<b>HOSES</b>			
<b>PVC</b>			
Hose PVC DN40 1 m	127	9.989-626.0	Electroconductive PVC hose, DN 40. Temperature-resistant up to 85 °C. Length: 1 m. <input type="checkbox"/>
Hose PVC DN40 3 m	128	9.989-962.0	<input type="checkbox"/>
Hose PVC DN40 5 m	129	9.989-963.0	<input type="checkbox"/>
Hose PVC DN50 3 m	130	9.989-964.0	<input type="checkbox"/>
Hose PVC DN50 5 m	131	9.989-965.0	<input type="checkbox"/>
Hose PVC DN40 3 m	132	9.989-647.0	PVC hose, DN 40. Temperature-resistant up to 85 °C and electrically conductive. Length: 3 m. <input type="checkbox"/>
Hose PVC DN40 5 m	133	9.989-614.0	Electroconductive PVC hose, DN 40. Temperature-resistant up to 85 °C. Length: 5 m. <input type="checkbox"/>
PVC hose DN40 15 m without connectors	134	9.989-633.0	PVC hose without tap adapter, DN 40. Electroconductive and temperature-resistant up to 85 °C. Length: 15 m. <input type="checkbox"/>
Hose PVC DN50 3 m	135	9.989-615.0	Electroconductive PVC hose, DN 50. Temperature-resistant up to 85 °C. Length: 3 m. <input type="checkbox"/>
Hose PVC DN50 5 m	136	9.989-616.0	Electroconductive PVC hose, DN 50. Temperature-resistant up to 85 °C. Length: 5 m. <input type="checkbox"/>
PVC hose DN50 15 m without connectors	137	9.989-634.0	PVC hose without tap adapter, DN 50. Electroconductive and temperature-resistant up to 85 °C. Length: 15 m. <input type="checkbox"/>
Hose PVC DN70 3 m	138	9.989-635.0	Electroconductive PVC hose, DN 70. Temperature-resistant up to 85 °C. Length: 3 m. <input type="checkbox"/>
Hose PVC DN70 5 m	139	9.989-643.0	PVC hose, DN 70. Temperature-resistant up to 85 °C and electroconductive. Length: 5 m. <input type="checkbox"/>
PVC hose DN70 15 m without connectors	140	9.989-636.0	PVC hose without tap adapter, DN 70. Electroconductive and temperature-resistant up to 85 °C. Length: 15 m. <input type="checkbox"/>

Available accessories.

## ACCESSORIES FOR IVM 60/36 -3 1.573-320.0



141-142, 144



143



145-146, 148-149,  
151-152



147, 150, 153

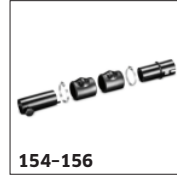

154-156

	Order no.	Description		
<b>HOSES</b>				
<b>EVA hoses</b>				
Hose EVA DN40 3 m	141	9.989-982.0	<input type="checkbox"/>	
Hose EVA DN40 5 m	142	9.989-983.0	<input type="checkbox"/>	
Hose EVA DN50 3 m	143	9.989-984.0	<input type="checkbox"/>	
Hose EVA DN50 5 m	144	9.989-985.0	<input type="checkbox"/>	
Hose EVA NW40 3 m	145	9.988-088.0	Electroconductive hose with NW 40. Suitable for temperatures up to 65°C. Length: 3 m.	<input type="checkbox"/>
Hose EVA NW40 5 m	146	9.988-089.0	Five-metre-long, electroconductive hose with NW 40. Suitable for temperatures up to 65°C. Length: 5 m.	<input type="checkbox"/>
EVA hose DN40 15 m without connectors	147	9.989-630.0	EVA hose without tap adapter, DN 40. Electroconductive and temperature-resistant up to 65 °C. Length: 15 m.	<input type="checkbox"/>
Hose EVA NW50 3 m	148	9.988-090.0	Electroconductive hose with NW50. Suitable for temperatures up to 65°C. Length: 3 m.	<input type="checkbox"/>
Hose EVA NW50 5 m	149	9.988-091.0		<input type="checkbox"/>
EVA hose DN50 15 m without connectors	150	9.989-631.0	EVA hose without tap adapter, DN 50. Electroconductive and temperature-resistant up to 65 °C. Length: 15 m.	<input type="checkbox"/>
Hose EVA DN70 3 m	151	9.989-613.0	Electroconductive EVA hose, DN 70. Temperature-resistant up to 65 °C. Length: 3 m.	<input type="checkbox"/>
Hose EVA DN70 5 m	152	9.989-624.0	Electroconductive EVA hose, DN 70. Temperature-resistant up to 65 °C. Length: 5 m.	<input type="checkbox"/>
EVA hose DN70 15 m without connectors	153	9.989-632.0	EVA hose without tap adapter, DN 70. Electroconductive and temperature-resistant up to 65 °C. Length: 15 m.	<input type="checkbox"/>
<b>Hose installation sets</b>				
Hose installation kit DN40	154	9.989-627.0	Multipiece hose connection set, DN 40.	<input type="checkbox"/>

Available accessories.

## ACCESSORIES FOR IVM 60/36 -3 1.573-320.0



154-156



157-158



159-162



163-167



168

		Order no.	Description	
<b>HOSES</b>				
<b>Hose installation sets</b>				
Hose installation kit DN50	155	9.989-628.0	Multipiece hose connection kit, DN 50.	<input type="checkbox"/>
Hose installation kit DN70	156	9.989-629.0	Multipiece hose connection kit, DN 70.	<input type="checkbox"/>
Hose connection kit, stainless steel AISI 304 DN40	157	9.989-986.0	Hose connection kit in nominal width DN 40, made of stainless steel. Contents: 1 hose connection piece, 1 hose connection (rotating), 2 hose clamps, 2 hose end pieces (black), 1 flat bag (PE plastic).	<input type="checkbox"/>
Hose connection kit, stainless steel AISI 304 DN50	158	9.989-987.0	Hose connection kit in nominal width DN 50, made of stainless steel. Contents: 1 hose connection piece, 1 hose connection (rotating), 2 hose clamps, 2 hose end pieces (black), 1 flat bag (PE plastic).	<input type="checkbox"/>
<b>PU hoses</b>				
Hose PU DN40 3 m	159	9.989-966.0		<input type="checkbox"/>
Hose PU DN40 5 m	160	9.989-967.0		<input type="checkbox"/>
Hose PU DN50 3 m	161	9.989-968.0		<input type="checkbox"/>
Hose PU DN50 5 m	162	9.989-969.0		<input type="checkbox"/>
Hose PU FDA DN40 3 m	163	9.989-970.0		<input type="checkbox"/>
Hose PU FDA DN40 5 m	164	9.989-971.0		<input type="checkbox"/>
Hose PU FDA DN40 15 m	165	9.989-972.0		<input type="checkbox"/>
Hose PU FDA DN50 3 m	166	9.989-973.0		<input type="checkbox"/>
Hose PU FDA DN50 5 m	167	9.989-974.0		<input type="checkbox"/>
Hose PU FDA DN50 15 m	168	9.989-975.0		<input type="checkbox"/>

Available accessories.

## ACCESSORIES FOR IVM 60/36 -3

### 1.573-320.0



		Order no.	Description	
<b>HOSES</b>				
<b>PU hoses</b>				
Hose PU DN40 3 m	169	9.989-617.0	Oil-resistant, electroconductive PU hose, DN 40. Suitable for abrasive suction media and temperature-resistant up to 80 °C. Length: 3 m.	<input type="checkbox"/>
Hose PU DN40 5 m	170	9.989-618.0	Oil-resistant, electroconductive PU hose, DN 40. Suitable for abrasive suction media and temperature-resistant up to 80 °C. Length: 5 m.	<input type="checkbox"/>
PU hose DN40 15 m without connectors	171	9.989-637.0	PU hose without tap adapter, DN 40. Electroconductive and temperature-resistant up to 80 °C. Length: 15 m.	<input type="checkbox"/>
Hose PU DN50 3 m	172	9.989-619.0	Oil-resistant, electroconductive PU hose, DN 50. Suitable for abrasive suction media and temperature-resistant up to 80 °C. Length: 3 m.	<input type="checkbox"/>
Hose PU DN50 5 m	173	9.989-620.0	Oil-resistant, electroconductive PU hose, DN 50. Suitable for abrasive suction media and temperature-resistant up to 80 °C. Length: 5 m.	<input type="checkbox"/>
PU hose DN50 15 m without connectors	174	9.989-638.0	PU hose without tap adapter, DN 50. Electroconductive and temperature-resistant up to 80 °C. Length: 15 m.	<input type="checkbox"/>
Hose PU DN70 3 m	175	9.989-644.0	Oil-resistant, electroconductive PU hose, DN 70. Temperature-resistant up to 80 °C, suitable for abrasive suction media. Length: 3 m.	<input type="checkbox"/>
Hose PU DN70 5 m	176	9.989-645.0	Oil-resistant, electroconductive PU hose, DN 70. Temperature-resistant up to 80 °C, suitable for abrasive suction media. Length: 5 m.	<input type="checkbox"/>
PU hose DN70 15 m without connectors	177	9.989-639.0	PU hose without tap adapter, DN 70. Electroconductive and temperature-resistant up to 85 °C. Length: 15 m.	<input type="checkbox"/>
<b>ME-PU-hoses</b>				
Hose ME DN40 3 m	178	9.989-976.0		<input type="checkbox"/>
Hose ME DN40 5 m	179	9.989-977.0		<input type="checkbox"/>
Hose without connection ME DN40 15 m	180	9.989-978.0		<input type="checkbox"/>
Hose ME DN50 3 m	181	9.989-979.0		<input type="checkbox"/>
Hose ME DN50 5 m	182	9.989-980.0		<input type="checkbox"/>

Available accessories.

## ACCESSORIES FOR IVM 60/36 -3 1.573-320.0



184-185



186-187



188-189



190-191



192-193



194



195



196

	Order no.	Description		
<b>HOSES</b>				
<b>ME-PU-hoses</b>				
Hose without connection ME DN50 15 m	183	9.989-981.0	<input type="checkbox"/>	
<b>HANDLES</b>				
Elbow aluminium 45° DN40	184	9.989-544.0	45° curved handle made from aluminium, DN 40.	<input type="checkbox"/>
Elbow aluminium 45° DN50	185	9.989-547.0	Handle with 45° bend. Made from aluminium, DN 50.	<input type="checkbox"/>
Handle stainless steel AISI 304 DN40	186	9.989-896.0		<input type="checkbox"/>
Handle stainless steel AISI 304 DN50	187	9.989-897.0		<input type="checkbox"/>
Handle straight stainless steel AISI 304 DN40	188	9.989-898.0		<input type="checkbox"/>
Handle straight stainless steel AISI 304 DN50	189	9.989-899.0		<input type="checkbox"/>
Handle carbon 45° DN-F40	190	9.989-916.0		<input type="checkbox"/>
Handle carbon 45° DN-F50	191	9.989-917.0		<input type="checkbox"/>
Handle carbon 110° DN-F40	192	9.989-918.0		<input type="checkbox"/>
Handle carbon 110° DN-F50	193	9.989-919.0		<input type="checkbox"/>
Handle DN 40	194	9.977-679.0	45° curved and electroconductive handle made from stainless steel. Inner cone DN 40.	<input type="checkbox"/>
Handle DN 50	195	9.977-678.0	Electroconductive and 45° curved handle made from stainless steel. Inner cone DN 50.	<input type="checkbox"/>
Handle DN 70	196	9.977-677.0		<input type="checkbox"/>

Available accessories.